

TATA INSTITUTE OF FUNDAMENTAL RESEARCH

An Autonomous Institution of the Department of Atomic Energy, Government of India (A Deemed University)

Plot No.36/P, Gopanpally Village, Serilingampally Mandal, Ranga Reddy District. Hyderabad, Telangana, India. PIN 500

107
,0

Email: , hone: 040-20203020, Email: jrathna@tifrh.res.in

Ref:TIFR/PD/CA21-83/210694

ENQUIRY

LIMITED TENDER

To

=> By Speed Post/Courier

The Bidders / Suppliers

Dear Sirs

Please let us have your Quotation for the following:

S.No.	Item Description	Qty	UOM
1	<p>Modular workbench of dimensions (2699 + 4302) L x 900D x 900H with following Specification. Quantity 1</p> <p>C frame with Granite: 60 x 40 x 2 mm CRCA square tube with 60-90 micron laboratory grade powder coating. C Frames are extremely steady and can be loaded with 200Kg/ Sqm. C frames are 7 tank processed. 20 mm Thick Jet black granites are used as worktop. Edges are polished to avoid sharp edges. Frames are fitted with easy removable locking type panels. Panels are made of 0.8 mm thickness with 60-90 micron thick powder coating. Frames are fitted with PP adjustable level jacks which is highly resistant to chemicals. 3 mm Neoprene rubbers are placed in between granite worktop frames to avoid the minor vibrations. C frames are made as per SEFA standard</p>	1.00	NO
2	<p>Underbench Units on Castor: Quantity 4</p> <p>Cabinets: 750 MM. Length, 2 Shutter, 1 drawer cabinets with castor wheel. Cabinets are made of 7 tank processed GPSP sheet of thickness 1.2 mm. 60-90 micron thickness powder coating. Cabinets are covered at the top. Drawers: Drawers with Nylon wheels. Draw channels are powder coated to avoid the rusting. Provided with Soft stop for drawer. Ball bearing drawer slides must not be used. Handle: Aluminium die cast handles without Joints. 200 mm length frozen SS finish, 20 mm Square block, Bottom hand grip. neat and elegant finish non recessed type. Door: Hinged doors with 270° SS 304 Hinges. Catcher with PP roller. All the front door and drawer panels are double wall filled with polystyrene, sound deafening, sandwiched type & recessed type. Castor: 4 Swivelling castors of load capacity of 200 Kg. Front 2 Castor wheel with locking mechanism. Cabinets are made as per SEFA Standard</p>	4.00	NO
3	<p>Wall side Reagent Rack: Quantity 1</p> <p>Dimension- 6850L x 250D x 1200H- 2 Tier Multi purpose Upright: 60-90 micron thickness Powder coated aluminium Multi purpose upright of size 100L x 30D x 2.5 thick mm. which supported from floor to make it extra stable. Telescopic adjustable shelves are provided. It can be adjusted mm wise. Shelves- Shelves are made of 10 mm thick toughened glass. 2 nos Shelves which is supported by adjustable holders. Specially designed aluminium profiles are provided to avoid bottle dropping. Electrical Trunking: 1800L x 120H x 70D aluminium powder coated electrical trunking with cutout provision for sockets. Front Covering Panel: Easy dismantling & assembling type 16 mm thick front covering</p>	1.00	NO

S.No.	Item Description	Qty	UOM
	panels. Reagent racks are made as per SEFA Standard.		
4	Tall Storage Cupboards : Quantity 4 Dimension: 900L x 500D x 2100H. MOC: GPSP skin passed sheet with 60-90 micron powder coated. Doors: Hinged glass doors with 270° SS 304 Butt Hinges.Catcher with PP roller. All the front doors are double wall filled with polystyrene,sound deafening, sandwiched type & recessed type. 5 mm thick glass toughened glasses are used. Shelves: 5 Nos of adjustable shelves are provided. Lock & Key: SS 304 locks are provided with 2 Nos of keys.	4.00	NO
5	Modular workbench of dimensions 15730L x 750D x 900H with following Specification. Quantity 1 C frame with Granite: 60 x 40 x 2 mm ERW, CRCA square tube with 60-90 micron laboratory grade powder coating. C Frames are extremely steady and can be loaded with 200Kg/ Sqm. C frames are 7 tank processed. 20 mm Thick Jet black granites are used as worktop. Edges are polished to avoid sharp edges. Frames are fitted with easy removable locking type panels.Panels are made of GI sheet of thickness 0.8 mm with 60-90 micron thick powder coating. Frames are fitted with PP adjustable level jacks which is highly resistant to chemicals. 3 mm Neoprene rubbers are placed in between granite worktop & frames to avoid the minor vibrations. C frames are made as per SEFA Standard	1.00	NO
6	Underbench Units on Castor: Quantity 9 Cabinets: 466 MM. Length, 1 Shutter, 1 drawer cabinets with castor wheel. Cabinets are made of 7 tank processed GPSP sheet of thickness 1.2 mm. 60-90 micron thickness powder coating. Cabinets are covered at the top. Drawers: Drawers with Ball bearing Nylon wheels. Draw channels are powder coated to avoid the rusting. Provided with Soft stop for drawer. Handle: Aluminium die cast handles without Joints. 200 mm length frozen SS finish, 20 mm Square block, Bottom hand grip. neat and elegant finish non recessed type. Door: Hinged doors with 270° SS 304 Hinges.Catcher with PP roller. All the front door and drawer panels are double wall filled with polystyrene,sound deafening, sandwiched type & recessed type. Castor: 4 Swivelling castors of load capacity of 200 Kg. Front 2 Castor wheel with locking mechanism. Cabinets are made as per SEFA Standard	9.00	NO
7	Sink Cabinets: Quantity 4 Plinth Type Cabinets: 900 MM. Length, 2 Shutters, cabinets. Cabinets are made of 16 mm thick Trespa Base to avoid the rust due to water. Trespa panels are High chemical resistance based on 24 hours SEFA 3 test method. Easy to clean and high resistance to most aggressive disinfectants and cleaning agents.Does not support bacterial growth. Handle: Aluminium die cast handles without Joints. 200 mm length frozen SS finish, 20 mm Square block, Bottom hand grip. neat and elegant finish Door: Hinged doors with 270° SS 304 Hinges.Catcher with PP roller Cabinets are made as per SEFA Standard	4.00	NO
8	PP Sink: Qty 1 Nos Quantity 4 Outer size- 650L x 450W x 305D Inner Size- 550L x 390W x 300D PP moulded Sink- 1 1/2" BSP Outlet connection. Black color with flexible waste pipe Bottle trap: Qty 1 No MOC PP Inlet Size- 1 1/2" BSP 3 way water tap: Qty 1 No Handle: Plastic, with media indication according to EN13792 Spout: Full swivel action Hose nozzle: Fixed plastic (can be unscrewed by hand from	4.00	NO

S.No.	Item Description	Qty	UOM
	angle valves, thread: male G3/8) Headwork: Rubber (wrist action lever: ceramic) Temperature range: 0-65°C Max. working pressure: 10 bar / 147 psi Metals: Brass Sealing: EPDM Make- Broen Peg Board-Qty 1 No GI powder coated Peg Board with 24 PP pegs + SS drain board Size: 600L x 600W		
9	Table mounted eye shower with two 45° Quantity 2 angled heads, incl. 1.5m inlet hose. Trigger operated including a built-in check valve and FLOWFIX for regulation of water flow (14 l/min). Min. working pressure: 1,5 bar. Make: broen	2.00	NO
10	Wall side Reagent Rack: Quantity 1 Dimension- 11700L x 250D x 1200H- 2 Tier Multi purpose Upright: 60-90 micron thickness Powder coated aluminium Multi purpose upright of size 100L x 30D x 2.5 thick mm.which supported from floor to make it extra stable. Telescopic adjustable shelves are provided. It can be adjusted mm wise. Shelves- Shelves are made of 10 mm thick toughened glass. 2 nos Shelves which is supported by adjustable holders. Specially designed aluminium profiles are provided to avoid bottle dropping. Electrical Trunking: 1800L x 120H x 70D aluminum powder coated electrical trunking with cutout provision for sockets. Front Covering Panel: Easy dismantling & assembling type 16 mm thick front covering panels. Reagent racks are made as per SEFA Standard.	1.00	NO
11	Modular Island bench of dimensions 4600L x 1500D x 900H with following Specification Quantity 4 C frame with Granite: 60 x 40 x 2 mm ERW, CRCA square tube with 60-90 micron laboratory grade powder coating. C Frames are extremely steady and can be loaded with 200Kg/ Sqm. C frames are 7 tank processed. 20 mm Thick Jet black granites are used as worktop. Edges are polished to avoid sharp edges. Frames are fitted with easy removable locking type panels.Panels are made of GI sheet of thickness 0.8 mm with 60-90 micron thick powder coating. Frames are fitted with PP adjustable level jacks which is highly resistant to chemicals. 3 mm Neoprene rubbers are placed in between granite worktop & frames to avoid the minor vibrations. C frames are made as per SEFA Standard	4.00	NO
12	Underbench Units on Castor: Quantity 8 Cabinets: 466 MM. Length, 1 Shutter, 1 drawer cabinets with castor wheel. Cabinets are made of 7 tank processed GPSP sheet of thickness 1.2 mm. 60-90 micron thickness powder coating. Cabinets are covered at the top. Drawers: Drawers with Ball bearing Nylon wheels. Draw channels are powder coated to avoid the rusting. Provided with Soft stop for drawer. Handle: Aluminium die cast handles without Joints. 200 mm length frozen SS finish, 20 mm Square block, Bottom hand grip. neat and elegant finish Door: Hinged doors with 270° SS 304 Hinges.Catcher with PP roller. All the front door and drawer panels are double wall filled with polystyrene,sound deafening, sandwiched type & recessed type. Castor: 4 Swivelling castors of load capacity of 200 Kg. Front 2 Castor wheel with locking mechanism. Cabinets are made as per SEFA Standard	8.00	NO
13	Underbench Units on Castor: Quantity 16 Cabinets: 750 MM. Length, 2 Shutter, 1 drawer cabinets with castor wheel. Cabinets are made of 7 tank processed GPSP sheet of thickness 1.2 mm. 60-90 micron	16.00	NO

S.No.	Item Description	Qty	UOM
	<p>thickness powder coating. Cabinets are covered at the top.</p> <p>Drawers: Drawers with Ball bearing Nylon wheels. Draw channels are powder coated to avoid the rusting. Provided with Soft stop for drawer.</p> <p>Handle: Aluminium die cast handles without Joints. 200 mm length froseen SS finish, 20 mm Square block, Bottom hand grip. neat and elegant finish</p> <p>Door: Hinged doors with 270° SS 304 Hinges.Catcher with PP roller. All the front door and drawer panels are double wall filled with polystyrene,sound deafening, sandwiched type & recessed type.</p> <p>Castor: 4 Swivelling castors of load capacity of 200 Kg.</p> <p>Front 2 Castor wheel with locking mechanism.</p> <p>Cabinets are made as per SEFA Standard</p>		
14	<p>Reagent Rack: Quantity 4</p> <p>Dimension- 4500L x 400D x 1200H- 3 Tier Multi purpose Upright: 60-90 micron thickness Powder coated aluminium Multi purpose upright of size 100L x 30D x 2.5 thick mm.which supported from floor to make it extra stable. Telescopic adjustable shelves are provided. It can be adjusted mm wise. Shelves- Shelves are made of 10 mm thick toughned glass. 2 nos Shelves which is supported by adjustable holders. Specially designed aluminium profiles are provided to avoid bottle dropping. Electrical Trunking: 1800L x 120H x 70D aluminum powder coated electrical trunking with cutout provision for sockets. Front Covering Panel: Easy dismantling & assembling type 16 mm thick front covering panels. Reagent racks are made as per SEFA Standard.</p>	4.00	NO
15	<p>Electrical Points: Quantity 96</p> <p>2 Nos of sockets with 2 nos of switch & front 6 module plate. 6/16 Amps socket. Northwest/ Equivalent make. Internal Cabling Not considered.</p>	96.00	NO
16	<p>Data Sockets: Quantity 32</p> <p>Computer socket outlet comprising of plate with RJ-45 Cat-6 outlets suitable for terminating with MS boxes.(Telephone and LAN) Make: D link/ Roma</p>	32.00	NO
17	<p>Service Pendant: Quantity 4</p> <p>Made of 1.2 mm thick GPSP sheet with 60-90 micron powder coating.Comprising of square sections running from ceiling to table top. approximate size of 200L x 110D x 2400H mm with 3 nos of access doors vertically.</p>	4.00	NO

NOTE :

Please submit the quotation along with Certificate of Local Content as per attached Annexure - A duly signed and stamped on Letterhead.

Please mention your GST Registration numbers on the quotation, proforma Invoice and Bills. Quotation should indicate make, delivery period, guarantee/warranty exact taxes applicable, etc.

The payment will be made only after delivery of the supply, satisfactory installation, commissioning and performance of the item/equipment. No Advance payment will be made except in case of furnishing valid Bank Guarantee from any nationalized/scheduled bank the B. G. shall be valid till the complete delivery is made at the site.

Quotation should be submitted in sealed envelope duly superscribing our enquiry reference and due date.

TIFR is a public funded research institute and is entitled to concessional rate of GST @ 5% for certain items supplied for research purpose vide notification no. 47/2017 dated 14th Nov, 2017. The offer should be submitted after fully considering the above notification.

Quotation sent by hand delivery / courier are to be deposited in the Tender Box kept at the Main Gate after obtaining stamp, date and signature of the Security Officer.

Due Date for submitting your offer is 13/10/2021.

Administrative Officer



Annexure - A

Certificate for Local Content

*We [name of manufacturer] hereby confirm in respect of quoted item(s) that Local Content is equal to or more than 50% and come under 'Class-I Local Supplier' Category. As being 'Class-I Local Supplier', we are eligible for Purchase Preference under 'Make in India' Policy vide Gol Order No.P-45021/2/2017-PP (B.E.-II) dated 15.06.2017 (subsequently revised vide orders dated 28.05.2018, 29.05.2019 and 04.06.2020)

OR

*We [name of manufacturer] hereby confirm in respect of quoted items(s) that Local Content is more than 20% but less than 50% and come under 'Class-II Local Supplier' Category.

The details of the location (s) at which the local value addition made is /are as under:

- 1.....
- 2.....
- 3.....

*Strike out whichever is not applicable

Date:

Seal & Signature of the Bidder

NOTE:

- Self-certification that the item offered meets the minimum local content (as above) giving details of the location(s) at which the local value addition is made in case the bidder wishes to avail the benefits under the make in India policy, if applicable.
- In cases of procurement for a value in excess of Rs. 10 crores, the local supplier shall be required to provide a certificate from the statutory auditor or cost auditor of the company (in the case of companies) or from a practicing cost accountant or practicing chartered accountant (in respect of suppliers other than companies) giving the percentage of local content to avail the benefits under the make in India policy, if applicable.

1. Introduction

2. Methodology

The study was conducted using a mixed-methods approach, combining quantitative data analysis with qualitative interviews. The quantitative data was collected through a survey of 100 participants, while the qualitative data was gathered from 15 in-depth interviews. The survey data was analyzed using statistical software, and the interview data was analyzed using thematic analysis. The results of the quantitative analysis showed a strong positive correlation between the variables of interest, while the qualitative analysis revealed several key themes that emerged from the participants' responses.

3. Results and Discussion

The results of the study indicate that there is a significant relationship between the variables studied. The quantitative data shows that as the independent variable increases, the dependent variable also tends to increase. This finding is supported by the qualitative data, which suggests that the underlying mechanisms of this relationship are complex and multifaceted.

4. Conclusion

In conclusion, the study has provided valuable insights into the relationship between the variables under investigation. The findings suggest that further research is needed to explore the underlying factors that influence this relationship, and to develop more effective interventions based on these findings.

PRODUCED BY AN AUTODESK STUDENT VERSION

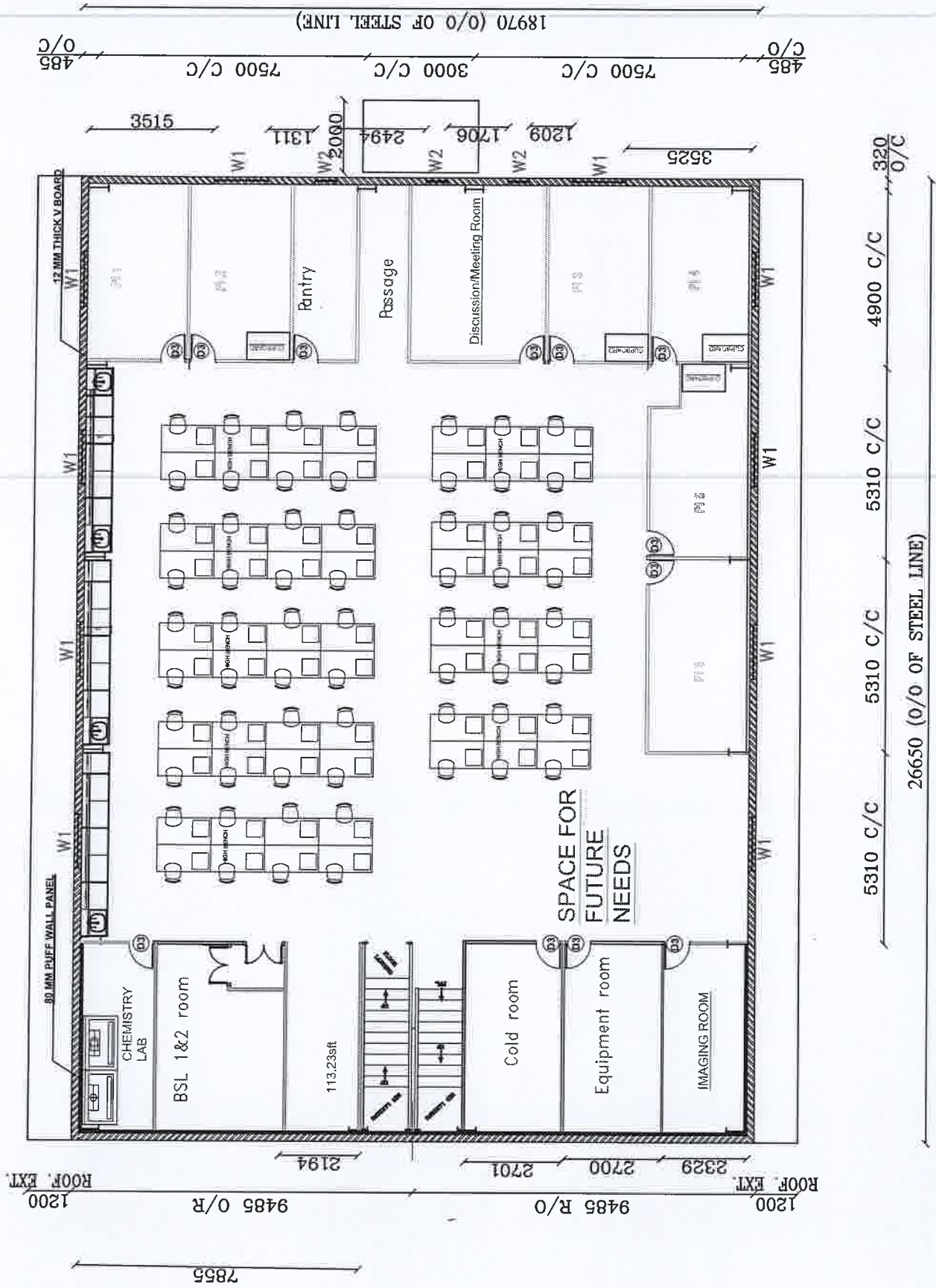

MEZZANINE FLOOR PLAN

PRODUCED BY AN AUTODESK STUDENT VERSION